

xGrind **Hydro**

High precision manual hydraulic chuck

The xGrind Hydro is a new, manually activated hydraulic chuck developed by GDS specifically for high precision tool grinding. The xGrind Hydro:

- Delivers excellent concentricity and repeatability
- Offers excellent dampening properties for uniform material removal, optimized feed rates, excellent surface finish, and significantly reduced grinding wheel wear

- Features a tapered profile and smaller nose diameter than other hydraulic holders for better wheel clearance and freedom from interference
- Tougher than competing systems and can be rebuilt economically for long term use
- The clamping screw is at a more ergonomic angle than competing systems, reducing the risk of injury
- NEW SafeGrip protects against slipping, for safe and easy handling
- Available in three diameters (12, 20 and 32 mm). Each chuck clamps its native diameter plus smaller diameters using standard intermediate sleeves:

- 12 mm chuck: Sleeves for 3-8 mm
- 20 mm chcuK: Sleeves for 3-18 mm
- 32 mm chuck: Sleeves for 6-25 mm

- Standard SK50 interface for nearly universal application



Delivery includes:

Actuating wrench

Item No.	Name	D	L
400005001	xGrind Hydro SK50 ø12	21.5	110
400005002	xGrind Hydro SK50 ø20	28	110
400005003	xGrind Hydro SK50 ø32	40	110



High precision manual collet chuck

Developed specifically for high precision tool grinding, the xGrind HPS uses the same innovative collets as the amazing μ Grind HPS. The xGrind HPS:

- Delivers excellent concentricity and repeatability
- Offers excellent dampening properties for uniform material removal, optimized feed rates, excellent surface finish, and significantly reduced grinding wheel wear
- Requires a relatively short clamping length on the blank to achieve constant holding force and concentricity
- Features a tapered profile and smaller nose diameter than hydraulic holders for better wheel clearance and freedom from interference
- Extremely durable, with very low wear over thousands of clampings, for economical performance
- The clamping screw is at a more ergonomic angle than competing systems, reducing the risk of injury
- Requires half the screw revolutions to clamp, versus other techniques, saving time
- Handles shanks from 3 to 20 mm ($\frac{1}{8}$ to $\frac{3}{4}$ inches)
- Standard SK50 interface for nearly universal application

Delivery includes:

Actuating wrench

Item No.	Name	D	L
400005000	xGrind HPS SK50	29.3	110

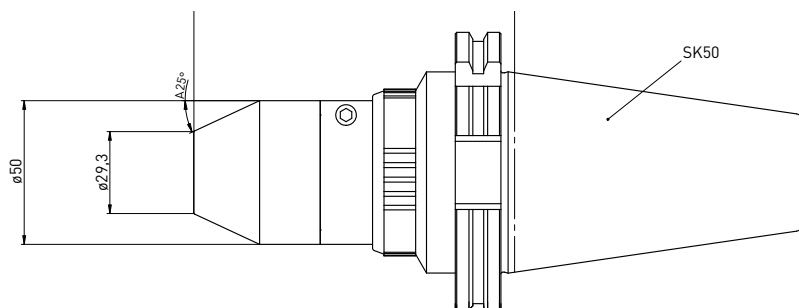

HPS 20 collets

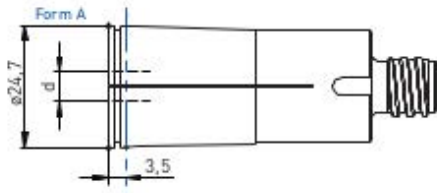

Flat face collets:

Item No.	Description - \varnothing
350260003	HPS Collet 20 - \varnothing 3 mm
350260004	HPS Collet 20 - \varnothing 4 mm
350260005	HPS Collet 20 - \varnothing 5 mm
350260006	HPS Collet 20 - \varnothing 6 mm
350260007	HPS Collet 20 - \varnothing 7 mm
350260008	HPS Collet 20 - \varnothing 8 mm
350260009	HPS Collet 20 - \varnothing 9 mm
350260010	HPS Collet 20 - \varnothing 10 mm
350260011	HPS Collet 20 - \varnothing 11 mm
350260012	HPS Collet 20 - \varnothing 12 mm
350260013	HPS Collet 20 - \varnothing 13 mm
350260014	HPS Collet 20 - \varnothing 14 mm
350260015	HPS Collet 20 - \varnothing 15 mm
350260016	HPS Collet 20 - \varnothing 16 mm
350260017	HPS Collet 20 - \varnothing 17 mm
350260018	HPS Collet 20 - \varnothing 18 mm
350260019	HPS Collet 20 - \varnothing 19 mm
350260020	HPS Collet 20 - \varnothing 20 mm
350260201	HPS Collet 20 - \varnothing 1/8 inch
350260202	HPS Collet 20 - \varnothing 3/16 inch
350260203	HPS Collet 20 - \varnothing 1/4 inch
350260204	HPS Collet 20 - \varnothing 5/16
350260205	HPS Collet 20 - \varnothing 3/8 inch
350260206	HPS Collet 20 - \varnothing 7/16 inch
350260207	HPS Collet 20 - \varnothing 1/2 inch
350260208	HPS Collet 20 - \varnothing 9/16 inch
350260209	HPS Collet 20 - \varnothing 5/8 inch
350260210	HPS Collet 20 - \varnothing 11/16 inch
350260211	HPS Collet 20 - \varnothing 3/4 inch

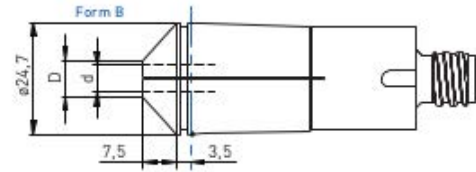

Short tapered collets:

Item No.	Description - \varnothing
350260130	HPS Collet 20 - \varnothing 2.35 mm
350260103	HPS Collet 20 - \varnothing 3 mm
350260104	HPS Collet 20 - \varnothing 4 mm
350260105	HPS Collet 20 - \varnothing 5 mm
350260106	HPS Collet 20 - \varnothing 6 mm
350260301	HPS Collet 20 - \varnothing 1/8 inch
350260302	HPS Collet 20 - \varnothing 3/16 inch
350260303	HPS Collet 20 - \varnothing 1/4 inch

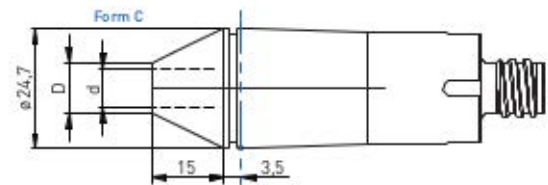

Tapered collets:

Item No.	Description - \varnothing
350260107	HPS Collet 20 - \varnothing 7 mm
350260108	HPS Collet 20 - \varnothing 8 mm
350260109	HPS Collet 20 - \varnothing 9 mm
350260110	HPS Collet 20 - \varnothing 10 mm
350260111	HPS Collet 20 - \varnothing 11 mm
350260112	HPS Collet 20 - \varnothing 12 mm
350260304	HPS Collet 20 - \varnothing 5/16
350260305	HPS Collet 20 - \varnothing 3/8 inch
350260306	HPS Collet 20 - \varnothing 7/16 inch
350260307	HPS Collet 20 - \varnothing 1/2 inch

Custom diameter collets also available. Visit www.toolroom.solutions/gds-super-chuck

Your **local** partner

In North America contact:

Toolroom Solutions Inc.

8824 Old Block House Ln
Spotsylvania, VA 22551 USA

Tel: +1 (540) 940-5977

Email: info@toolroom.solutions

Web: www.toolroom.solutions

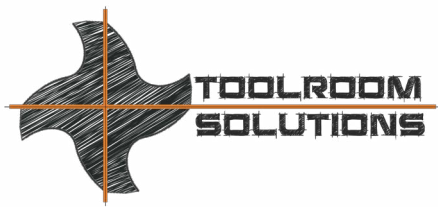

HPS collets have a specialized design and shallow taper ($<1^\circ$) for outstanding clamping force, wear resistance, and repeatability